

2.7 Pool Replacement

The following cost numbers are shown for the purpose of comparison and budgeting for a swimming pool replacement. The list of items addressed is not intended to list every possible option, but the main items discussed in the report. As an advisory, it is important to note that additional items undiscovered in the depth of this report could affect overall costs and should be discussed with the eventual project designer. Such items may be the presence of potential hazardous materials, original construction products that may have been defective or have a shorter useful life than anticipated for similar or alternative products used for the same purpose, and potential issues associated with budgeting practices.

Opinion of Probable Cost for a New Shallow Water Instructional/Lap Pool

This option includes a Lap Pool that is 6-lanes by the length of 25-yards with a skimmer type recirculation system. This layout has one shallow end with one stair, water depths ranging from 3'-6" to 7'-0" which allows for recreation, instruction, and lap swimming. This pool includes an ADA Accessible lift and is meant as a recreational body of water for lesson teaching, recreation and club level competition.

Our Opinions of Probable Construction Cost include a contingency and standard manufacturer pricing. Soft costs including typical design fees have also been included.

Please refer to the following for the costs associated with building a new pool as described in the above paragraph.

• Pool	=	\$854,900
• Deck Equipment	=	\$75,900
• Loose Equipment	=	\$7,400
• Maintenance Equipment	=	\$8,650
• Safety Equipment	=	\$1,600
• Pool Deck	=	\$117,200
•Pool Project Cost Subtotal	=	\$1,065,650

*NOTE: Assuming a skimmer type recirculation system.

Estimated Opinion of Probable Cost for Pool Replacement = **\$1,065,700**

Facility Condition Assessment

Discovery Bay Swimming Pool ■ Discovery Bay, CA
February 6, 2019 ■ Terracon Project No. BE186102



Opinion of Probable Cost for a New Shallow Water Instructional/Lap Pool with a small "L" section for instruction

This option includes a Lap Pool that is 6-lanes by the length of 25-yards with a skimmer type recirculation system. This layout has a small "L" section, approximately 100 square feet, with shallow water and a stair, water depths in the main body of the pool ranging from 4'- 0" to 7'- 0" which allows for recreation, instruction, and lap swimming. This pool includes an ADA Accessible lift and is meant as a recreational body of water for lesson teaching, recreation and club level competition.

Our Opinions of Probable Construction Cost include a contingency and standard manufacturer pricing. Soft costs including typical design fees have also been included.

Please refer to the following for the costs associated with building a new pool as described in the above paragraph.

• Pool	=	\$877,300
• Deck Equipment	=	\$75,900
• Loose Equipment	=	\$7,400
• Maintenance Equipment	=	\$8,650
• Safety Equipment	=	\$1,600
• Pool Deck	=	\$117,500
•Pool Project Cost Subtotal	=	\$1,088,350

*NOTE: Assuming a skimmer type recirculation system.

Estimated Opinion of Probable Cost for Pool Replacement = **\$1,088,500**

Facility Condition Assessment

Discovery Bay Swimming Pool ■ Discovery Bay, CA
February 6, 2019 ■ Terracon Project No. BE186102



Opinion of Probable Cost for a New Shallow Water Instructional/Lap Pool with a larger “L” section for instruction

This option includes a Lap Pool that is 6-lanes by the length of 25-yards with a skimmer type recirculation system. This layout has a small “L” section, approximately 100 square feet, with shallow water and a stair, water depths in the main body of the pool ranging from 4'- 0” to 7'- 0” which allows for recreation, instruction, and lap swimming. This pool includes an ADA Accessible lift and is meant as a recreational body of water for lesson teaching, recreation and club level competition.

Our Opinions of Probable Construction Cost include a contingency and standard manufacturer pricing. Soft costs including typical design fees have also been included.

Please refer to the following for the costs associated with building a new pool as described in the above paragraph.

• Pool	=	\$911,000
• Deck Equipment	=	\$75,900
• Loose Equipment	=	\$7,400
• Maintenance Equipment	=	\$8,650
• Safety Equipment	=	\$1,600
• Pool Deck	=	\$117,900
•Pool Project Cost Subtotal	=	\$1,122,450

*NOTE: Assuming a skimmer type recirculation system. \$/SF includes pool structure, pool finish, pool piping, pool mechanical equipment and pool deck and loose equipment.

Estimated Opinion of Probable Cost for Pool Replacement = \$1,122,500

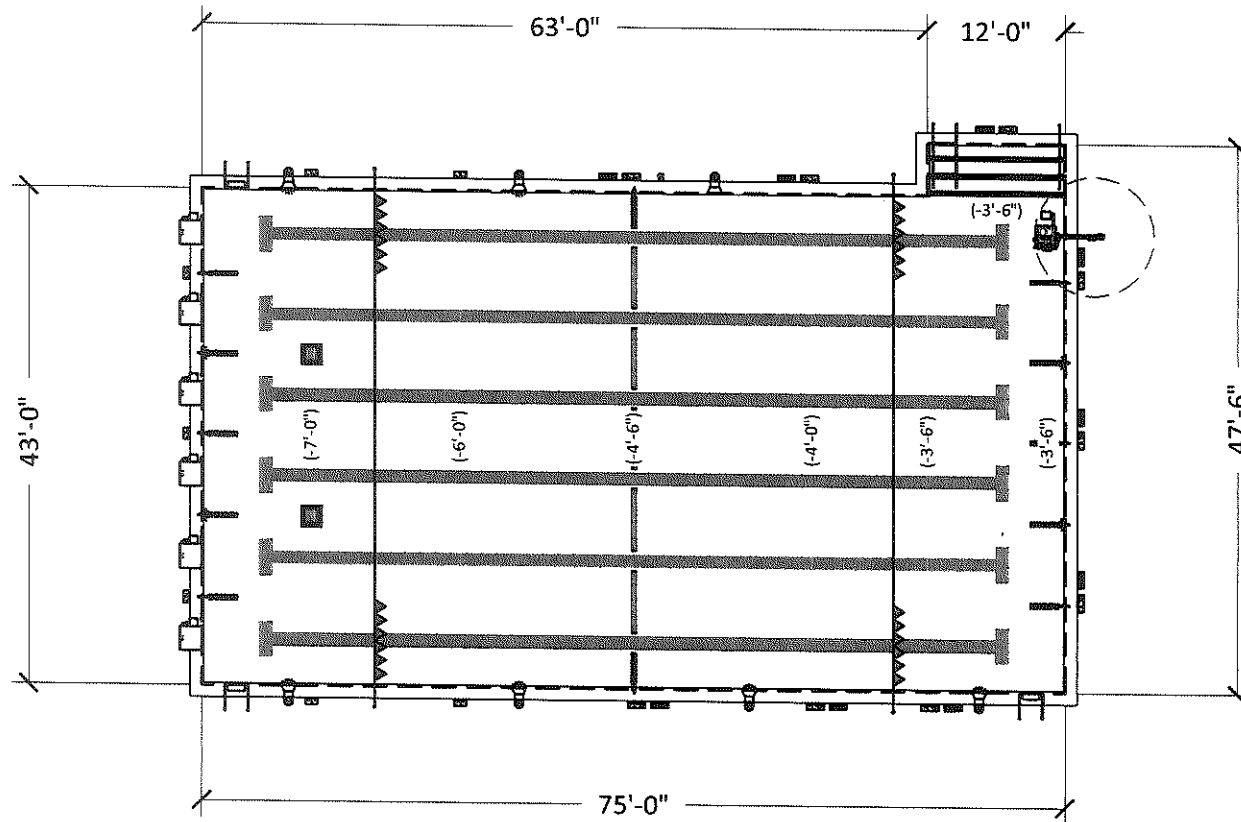

Terracon

25 YARD SWIMMING POOL PLAN
 DISCOVERY BAY SWIMMING POOL
 1601 DISCOVERY BAY BOULEVARD
 DISCOVERY BAY, CALIFORNIA

OPTION

1

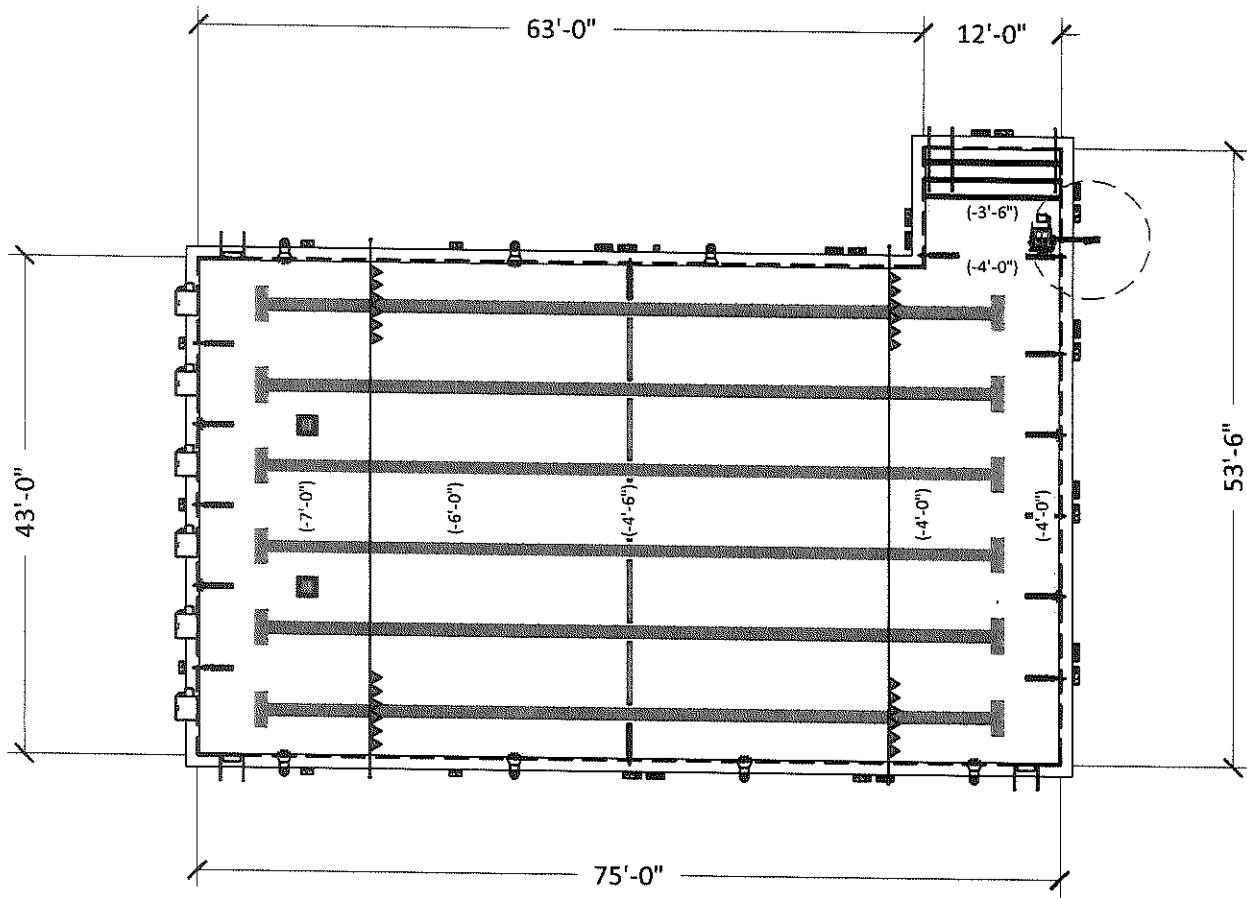

Terracon

25 YARD SWIMMING POOL PLAN
 DISCOVERY BAY SWIMMING POOL
 1601 DISCOVERY BAY BOULEVARD
 DISCOVERY BAY, CALIFORNIA

OPTION

2

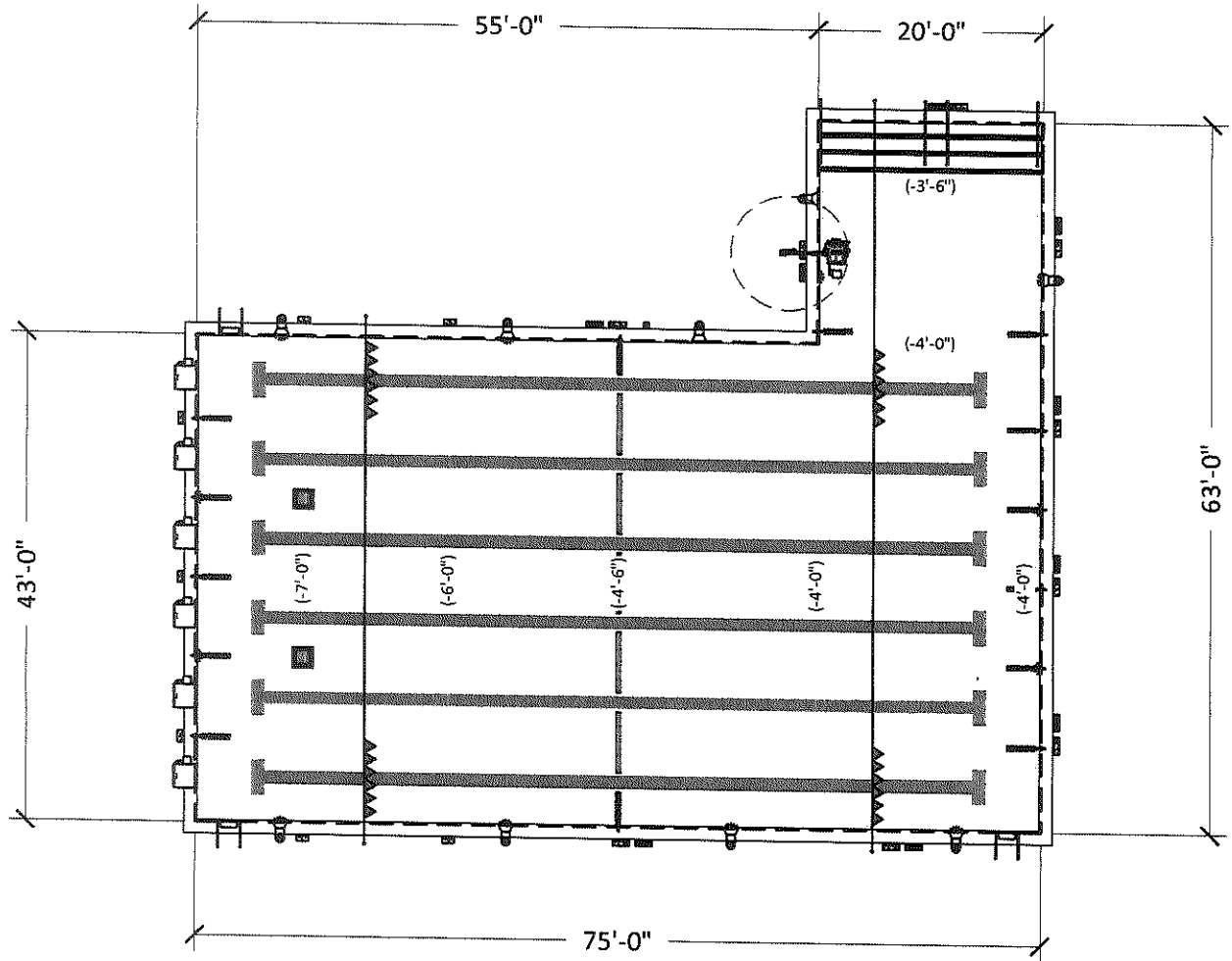

Terracon

25 YARD SWIMMING POOL PLAN
 DISCOVERY BAY SWIMMING POOL
 1601 DISCOVERY BAY BOULEVARD
 DISCOVERY BAY, CALIFORNIA

OPTION

3